



**MELT PRESSURE  
TRANSDUCERS & TRANSMITTERS**  
300 Industrial Drive, Grand Island, NY 14072 USA  
Tel. (716)775-8830 • Fax (716)775-8020 • sales@gp50.com • www.gp50.com

## Product Specification Sheet

### FLANGE MOUNTED LOW PRESSURE TRANSDUCER/TRANSMITTER

**Models 130, 230, 330**

**131, 231, 331 with FX/FY option**

#### MODELS 130, 230, 330

These are the rigid stem versions of GP:50's plastic melt pressure transducers. Standard length is 3.65 inches, although they may be ordered in longer or shorter lengths to accommodate individual needs (See outline drawing & close up). The limiting minimums may be the die temperature and environment which must jointly combine to restrict the electronics and sensor from exceeding 180°F.



**\*REFER TO APPENDIX A  
FOR WIRING CODES\***

#### FEATURES:

- All-welded, stainless steel construction
- State-of-the-art circuitry allows heavier diaphragm and increase fatigue life
- Standard options for every requirement
- Zero & Span controls, approximately  $\pm 20\%$  FSO (2XX + 3XX only)

#### PRESSURE RANGES:

- From 0-25 through 0-1,000 psig (See ordering guide)

#### ACCURACY:

- 0.5% FSO

#### MODEL 30-FY

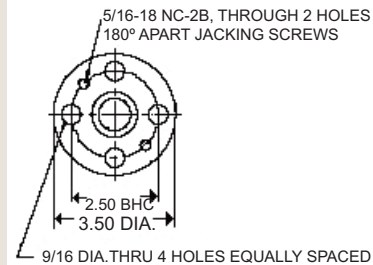
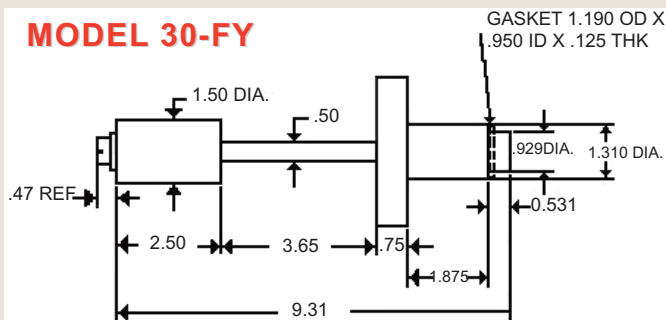

#### MODEL 30-FX

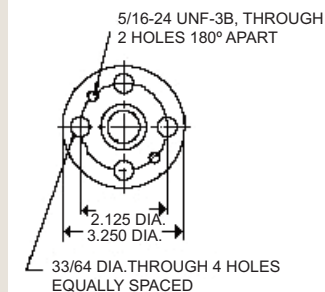
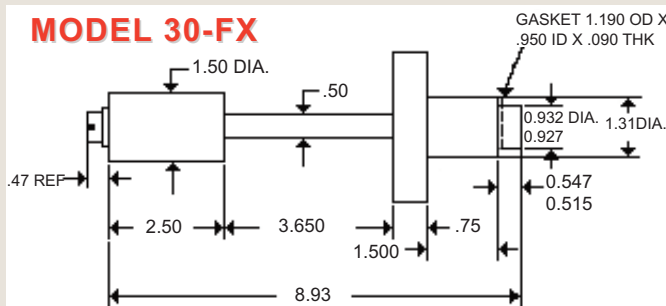

GP:50 reserves the right to make product improvements and amendments to the product specifications stated throughout this brochure without prior notification. Please contact the factory on all critical dimensions and specifications for verification.



## MELT PRESSURE TRANSDUCERS & TRANSMITTERS

300 Industrial Drive, Grand Island, NY 14072 USA  
Tel. (716)775-8830 • Fax (716)775-8020 • sales@gp50.com • www.gp50.com

### MODELS 131, 231, 331

The flexible tube version of the product line provides the ultimate in thermal isolation for those demanding applications reaching 750°F. Models 131, 231, and 331 come with an 18 inch length of flexible capillary tubing protected with a stainless steel armored jacket. This flexible capillary can be provided in shorter or longer lengths.

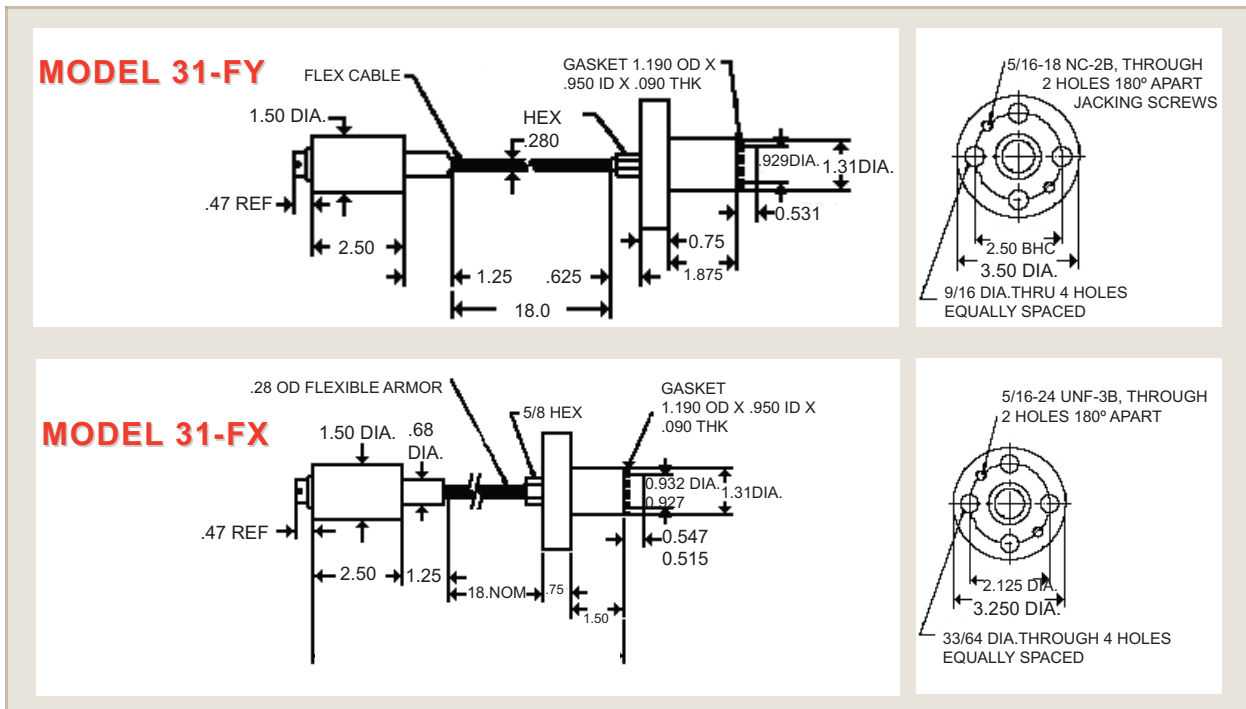

Use the following codes to identify desired item.

MODEL	RANGE	OPTIONS
•	—	•/•/•

Example: 130-PO-FX/CC

#### MODEL

130/131	3.33 mV/V
230/231	0-5 Vdc
330/331	4-20 mA

#### PRESSURE RANGE

(PSI)	(BAR)
PO 25	UL 2
PT 30	UM 3
PV 50	UN 5
PX 75	UP 7.5
PZ 100	UQ 10
RB 150	UR 15
RD 200	US 20
RE 250	UT 30
RF 300	UV 50
RH 500	UX 75
RJ 600	
RK 750	
RM 1000	

#### OPTIONS

AA None (standard connector PTIH-10-6P)

#### ALTERNATE CONNECTOR OR CABLE

CC Bendix PC02E-12-8P (8 pin)

CD Cannon WK6-32S

CF 1/2" NPT(M) thread w/ 36" potted leads for conduit conn.

#### GENERAL

FX 3.25" Flange (2.03 Standard snout length)

FY 3.50" Flange (2.41 Standard snout length)

GB Alternate Electronic Output - specify zero and span output values

GN 12.5" Rigid Stem

GO 9" Rigid Stem

GP Hastelloy C-276 Diaphragm and Nose

GS 0-10 Vdc FSO, Model 2XX only, (Requires 16-32 Vdc excitation)

GT 30" Armored Capillary Tube

GV Silicone Oil Fill. (Increases Thermal Shift) Consult factory, 600°F max

GX Mineral Oil Fill. (Increases Thermal Shift) Consult factory, 600°F max

GZ Customer Special

HS 9" Armored Capillary Tube

HT 24" Rigid Stem

HU 4" Rigid Stem

HV 24" Armored Capillary Tube

HY 12" Armored Capillary Tube

MO Gentran Wiring

MP Barber-Coleman Wiring

QB Custom Nameplate



**MELT PRESSURE  
TRANSDUCERS & TRANSMITTERS**

300 Industrial Drive, Grand Island, NY 14072 USA

Tel. (716)775-8830 • Fax (716)775-8020 • sales@gp50.com • www.gp50.com

Specifications reflect standard product, improved performance/mechanical options available. Modifications may alter specs, consult factory for more information.

<b>Full Scale Pressure Ranges</b>	<b>See ordering guide</b>	
<b>Accuracy</b>	<b>Static Error Band (Non-linearity, Hysteresis, Non-repeatability)</b> ± 0.5% FSO(RSS)	
<b>Material in Contact with Pressure Media</b>	316 stainless steel	
<b>Proof Pressure</b>	2 times full scale pressure range	
<b>Temperature Limits</b>	750°F (400°C) Standard fill 176°F (80°C)	
<b>Temperature Effects</b>		
From Diaphragm		
Zero	2 psi/100°F	
From Strain Gauge Housing		
Zero	Less than ± 1.0% FSO/100°F (± 2.0% FSO/100°C)	
Span	Less than ± 1.0% FSO/100°F (± 2.0% FSO/100°C)	
<b>Electricals</b>	<b>Excitation Voltage</b>	<b>Output at 70° F</b>
(Model 130/131)	3.5-15 Vdc	3.33 mV/V ± 2% FSO
(Model 230/231)	9-40 Vdc	5.0 Vdc ±2% FSO
(Model 330/331)	9-36 Vdc	4-20 mA ±2% FSO
Zero Balance		
(Model 130/131)	0.0 mV/V ±5% FSO at 70°F, vertical tip down	
(Model 230/231)	0.0 Vdc ±5% FSO at 70°F, vertical tip down	
(Model 330/331)	4.0 mA ±5% FSO at 70°F, vertical tip down	
Input Impedance		
(Model 130/131)	350 ohm, nominal	
Input Current		
(Model 230/231)	8 mA nominal	
Load Impedance		
(Model 130/131)	50,000 ohms minimum for less than 0.1% FSO attenuation	
(Model 330/331)	1350 ohms max. at 36 Vdc & 750 ohms at 24 Vdc	
Output Current		
(Model 230/231)	2.0 mA maximum for less than 0.1% FSO attenuation	
Range Cal. Signal	80% ±0.5% FSO standard	
<b>Connections</b>		
Pressure	3.25" OD Flange (FX option) 3.50" OD Flange (FY option)	
Electrical	PTIH-10-6P, standard PT06A-10-6S (SR), standard mate (not included) See options.	
<b>Enclosed Materials</b>	316 stainless steel	
<b>Mounting Torque</b>	110 inch pounds, maximum	
<b>Identification</b>	Etched stainless steel nameplate welded to body.	